

YOUR QUESTIONS ANSWERED



How will traffic be managed?

The development proposal includes a second entrance (and exit) point for the site. This is located on the southern side of the site, near the intersection of Blain St and Walsh Ave. The second entry has been purposefully included in the design to disburse the additional traffic and avoid loading up the current site entrance at the intersection of Blain St and Yeates Ave and is included as part of the Stage 1 development. The site design has also purposefully located the new entry opposite parkland to minimise headlight impact of departing vehicles.

In addition, with the intent to reduce or eliminate the potential bottleneck at the existing entrance, The Village on Blain intends to introduce smart locks to all existing and new rooms which allow guest to 'check-in' before arriving on site, receive their digital room key to their phone and go directly to their room. This is expected to reduce current check-in activity at the entrance / office by 70%. During construction the team will utilise a Traffic Management Plan and seek to limit disruptions.

How long is the accommodation expected to be needed for?

We anticipate and expect the remaining life of The Village on Blain as temporary workers accommodation to be a minimum of 20 years.

How do you ensure the well-being of your guests?

The Village on Blain has an excellent record of being a peaceful space for guests to have a home away from home. We pride ourselves on the creating a genuine village feel, with lush, well-maintained and heavily landscaped grounds. We know our guests work very hard so our amenities need to ensure that they are well-rested and have excellent quality and nutritional food options. We purposefully don't include other amenities like gyms and a pool in our Village as we know these already exist in town and will benefit from our guests visiting and being a customer of these businesses. We also actively ask for and seek feedback from our guests to ensure that we are continuing to improve our offering.

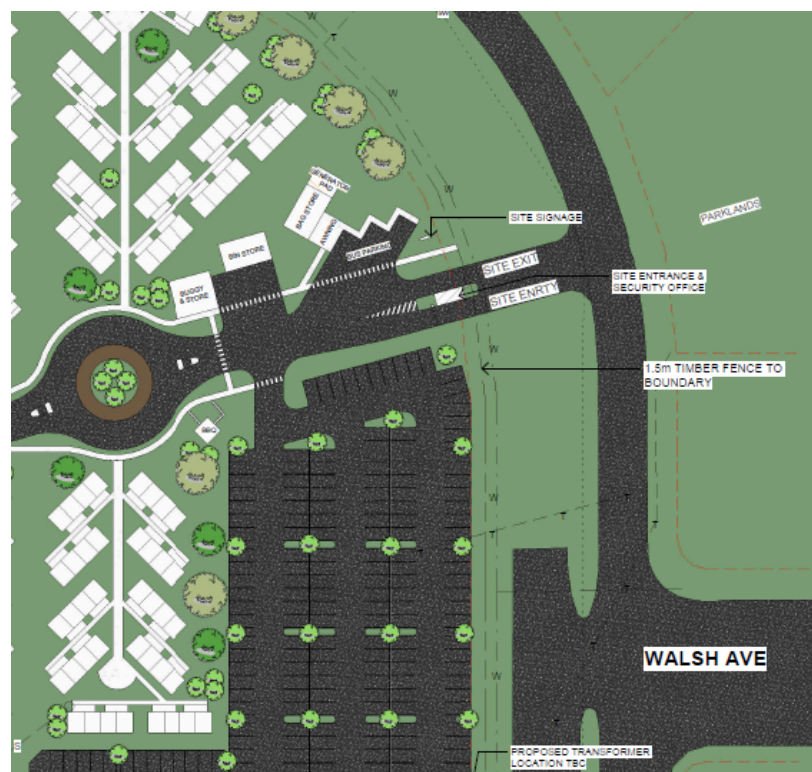

A proposed new second entry/exit off Blain Street (eastern end) is proposed to assist with better traffic flow throughout the site and ease pressure off the existing Village access on the western end of Blain Street.

“Your accommodation is amazing. VERY Clean - it's exceptional. Food is amazing and fresh and is the best potato bake I HAVE EVER HAD. YOUR STAFF ARE LOVELY. October 2024”



Further information visit

www.tvob.com.au